

STEP 1:

COMPLETE PAPERWORK



For tips on sample collection and shipping please see the back

Make an appointment with your healthcare provider to complete and sign the test request form included. Once signed and completed, verify all information is accurate and add the following information:

- **Date you collected your sample** to the test request form

SPECIMEN COLLECTION DATE (REQUIRED)

- Your **insurance information** & a copy of your **insurance cards**

6. Billing/Payment Information

OPTION 1: BILL INSURANCE (Please attach copy of authorization/referral)

Name of Policy Holder: _____ DOB: ____/____/____

Insurance ID# _____ Patient Relation to Policy Holder: Self Spouse Child Other _____ Authorization/Referral# _____

OPTION 2: PATIENT PAYMENT (Please call Customer Service for questions regarding this option or for credit card payment)

OPTION 3: OTHER BILLING (To establish an account, submit billing information with this form)

Bill me (institutional account # _____ or established research contact code # _____)

I understand that Myriad will contact me if I will be financially responsible for any non-covered service. To be considered for the Myriad Financial Assistance Program, please provide the following information: Annual household income \$ _____ Number of family members in household _____

STEP 2:

COLLECT SAMPLE

Now it's time to provide your saliva sample. Please **DO NOT** eat, drink, smoke, or chew gum for at least 30 minutes before giving your sample.



1. OPEN clear plastic box and remove collection tube

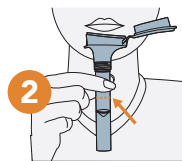

2. SPIT into tube until the amount of saliva (not bubbles) reaches the fill line



3. CLOSE lid on funnel lid until a loud click is heard

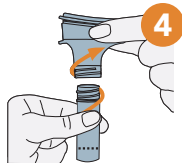

4. UNSCREW FUNNEL from top of tube

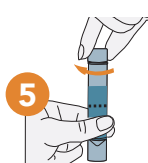

5. Use small cap to CLOSE tube tightly

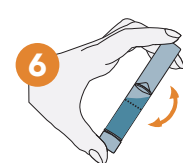

6. SHAKE closed tube for at least 5 seconds

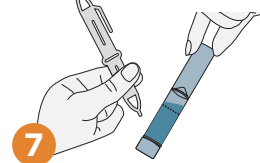

7. LABEL your sample by writing your name and date of birth on the tube, ensuring that it matches the test request form.

STEP 3:

PACKAGE EVERYTHING UP



- Place the closed tube back into the plastic tray. You may discard the funnel lid.
- Remove the plastic bag and mailing label from the test kit
- Place all other materials including the sample and any paperwork back into the test kit
- Close the test kit and place it into the provided plastic bag, then seal shut

STEP 4:

SHIP YOUR SAMPLE

You have two options to send your sample to Myriad.

1. Place FedEx label found in test kit on top of the existing label, then drop off at a FedEx location ([fedex.com/en-us/shipping.dropbox.html](https://www.fedex.com/en-us/shipping.dropbox.html)).

OR

2. Ship from home with existing US Postal Service label that is on the plastic bag.



You have access to Pre and Post-Test consults with a patient educator, a board-certified genetic counselor at no additional cost.



PRE-TEST EDUCATION

Speak with a certified genetic counselor at Myriad if you have any questions about genetic testing. Call **888-356-0630**.



POST-TEST EDUCATION CONSULT

To help answer any questions that you may have about your result, go to **my.myriad.com/consults**. You will need your accession number located at the top of your result.

TIPS

- It can sometimes take a while to produce enough saliva. Try rubbing your cheeks, pretend you are chewing, or think of (or smell) lemons to stimulate saliva production
- Make sure to spit into the funnel until the amount of liquid saliva (not bubbles) reaches the fill line
- Please place all papers that were included with the kit back inside before mailing
- Keep sample at room temperature after collection and before shipping
- Any leftover packaging may be thrown away
- Ship sample within 1-2 days of collection of saliva

MYWAYPTINSOTP 10/20



INSTRUCTIONS ON
SUBMITTING YOUR SAMPLE